

Product leaflet

| | | |
|----------------------------------|------------------|---------------------|
| Product | Model No. | Ordering No. |
| Powered air purifying respirator | SR 500 | H06-0112 |

Product Description

The SR 500 is a battery-powered fan that, together with a filter and an approved head top, is included in the Sundström fan-assisted respiratory protective device systems. The SR 500 can be used as an alternative to filter respirators in all situations in which these are recommended. This applies particularly to work that is hard, warm or of long duration.

The human interface may consist of a hood, face shield, half mask or full face mask. The fan is equipped with a filter, and the filtered air is fed through a hose to the human interface. The pressure then generated prevents surrounding pollutants from penetrating into the mask.

The characteristics of the SR 500 are as follows:

The battery is of lithium-ion type • Two battery alternatives, i.e. STD (Standard 2.2 Ah) and HD (Heavy Duty 3.6 Ah) • The charging time for the Standard battery is around 1.5 hours and for the Heavy Duty battery, about 2 hours • Equipped with two filters/combined filters • Operating time of up to 13 hours • The same control is used for starting, stopping and selection of operating status • Display with symbols • Equipped with automatic air flow control with compensation for air pressure and temperature • Can be used together with hoods SR 520, SR 530, SR 561, SR 562, face shield SR 540, half mask SR 900, full face mask SR 200, welding shield SR 590, helmet with visor SR 580 or welding shield/helmet with visor SR 584/SR 580.

Electronics ingress protection is approved in IP class IP67 according to IEC / EN 60529.

The SR 500 is also available in an explosion-protected version designated the SR 500 EX for use in a potentially explosive atmosphere (ATEX Directive 94/9/EC). See the separate product leaflet.

Technical specification

| | SR 500 | EN 12941:1998 + A2:2008 | EN12942:1998 + A2:2008 |
|---|--|-------------------------|------------------------|
| Air flow, min/max | 175/240 l/min | ≥ 120 l/min | - |
| STD-battery/HD-Battery | 14.8V, 2.2 Ah/3.6 Ah | - | - |
| Operating times at 175/240 l/min: | | | |
| P3, STD-battery | 8 h (7 h ³)/5 h (4 h ³) | ≥ 4 h | ≥ 4 h |
| P3, HD- battery | 13 h (12 h ³)/8 h (7 h ³) | ≥ 4 h | ≥ 4 h |
| Weight with STD-battery and P3 filter | ≈ 1 350 g | ≤ 3,500 g | ≤ 3,500 g |
| Service conditions | -10 °C to +55 °C, < 90% RH, 600 to 1200 hPa | - | - |
| Storage conditions | -20 °C to +40 °C, < 90% RH | - | - |
| Low flow warning level | < 175 l/min | ≤ 175 l/min | ≤ 175 l/min |
| Assigned Protection Factor¹: SR 520, SR 530, SR 540, SR 561/562, SR 580, SR 584, SR 590 | 40 (TH3) | - | - |
| Assigned Protection Factor¹ SR 200 | 40 (TM3) | - | - |
| Nominal Protection Factor² SR 520, SR 530, SR 540, SR 561/562, SR 580, SR 584, SR 590 | 500 (TH3) | - | - |
| Nominal Protection Factor² SR 200 | 2000 (TM3) | - | - |
| Approvals | EN 12941:1998 + A2:2008 EN 12942:1998 + A2:2008 | - | - |

1) Specified in BS 4275 and applies generally to all approved fan-assisted respiratory protective devices, regardless of the test results.

2) According to EN 529:2005.

3) SR 900 + SR 951/SR 952.



Head Office

Tel: +46-(0)8-562 370 00
Fax: +46-(0)8-562 370 20

Visiting address:
Stockholmsvägen 33
SE-181 33 Lidingö

Factory

Tel: +46-(0)8-562 370 00
Fax: +46-(0)8-562 370 60

Visiting address:
Västergatan 4
SE-341 50 Lagan

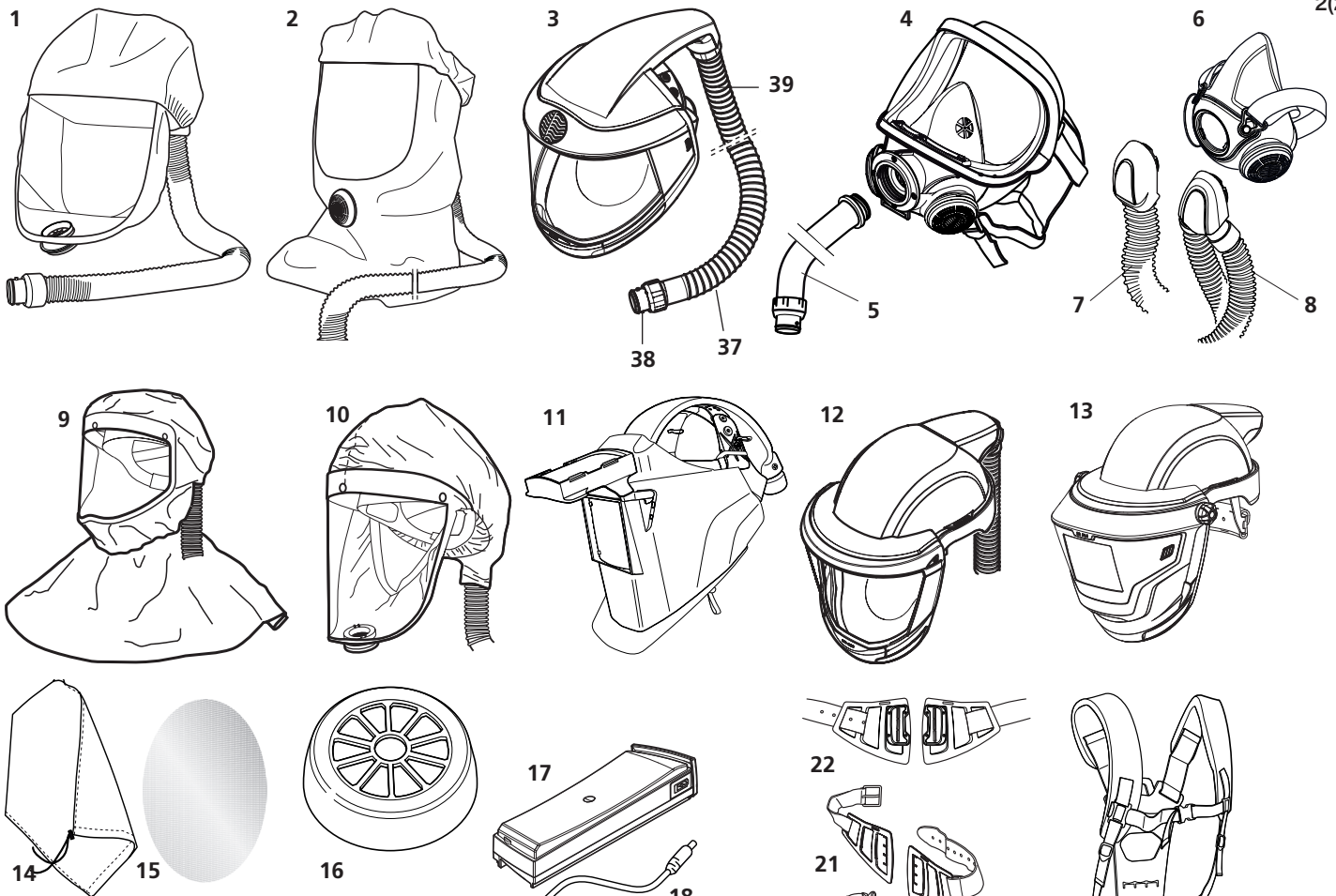

Head-tops, spare parts and accessories

Item

| No. Part | Ordering No. |
|--|--------------|
| 1. Hood SR 520 M/L | H06-0212 |
| 1. Hood SR 520 S/M | H06-0312 |
| 2. Hood SR 530 | H06-0412 |
| 3. Face shield SR 540 | H06-0512 |
| 4. Full face mask SR 200, PC visor | H01-1212 |
| 4. Full face mask SR 200, glass visor | H01-1312 |
| 5. PU hose SR 550 for SR 200 | T01-1216 |
| 5. Rubber hose SR 551 for SR 200 | T01-1218 |
| 6. SR 900 S | H01-3012 |
| 6. SR 900 M | H01-3112 |
| 6. SR 900 L | H01-3212 |
| 7. Hose SR 951 | T01-3003 |
| 8. Twin hose SR 952 | R01-3009 |
| 9. Hood SR 561 | H06-5012 |
| 10. Hood SR 562 | H06-5112 |
| 11. Welding shield SR 590 | H06-4012 |
| 12. Helmet with visor SR 580 | H06-8012 |
| 13. Welding shield/Helmet with visor SR 584/SR 580 | H06-8310 |
| 14. Flow meter SR 356 | R03-0346 |
| 15. Steel net disc SR 336 | T01-2001 |
| 16. Asbestos Kit SR 509 | T06-0105 |
| 17. Battery SR 501, 2,2 Ah | R06-0108 |
| 17. Battery HD SR 502, 3,6 Ah | T06-0101 |
| 18. Battery charger SR 513 | R06-0103 |
| 19. Charging station without chargers SR 506 | T06-0108 |
| 19. Charging station, complete SR 516 | T06-0111 |
| 20. Belt SR 508 | R06-0101 |
| 20. Rubber belt SR 504 | T06-0104 |
| 21. Leather belt SR 503 | T06-0103 |
| 22. HD belt SR 553, standard | T06-0119 |
| 22. HD belt SR 553, large | T06-0120 |
| 23. Harness SR 552 | T06-0116 |
| 24. Fan SR 500, bare | R06-0110 |
| 25. Splash cover SR 514 | T06-0114 |
| 26. Storage bag SR 505 w two compartments | T06-0102 |
| 27. Pre-filter holder SR 512 | R06-0106 |
| 28. Pre-filter SR 221 | H02-0312 |
| 29. Particle filter P3 R, SR 510 | H02-1312 |
| 30. Filter adapter SR 511 | R06-0105 |
| 31. Pre-filter holder SR 5153 for SR 710 | R01-0604 |
| 32. Particle filter P3 R, SR 710 | H02-1512 |
| 33. Gas filter A2, SR 518 | H02-7012 |
| 34. Gas filter ABE1, SR 515 | H02-7112 |
| 35. Gas filter A1BE2K1, SR 597 | H02-7212 |
| 36. Combined filter A1BE2K1-Hg-P3 R, SR 599 | H02-7312 |
| 37. Hose SR 541 for SR 540 | R06-0501 |
| 38. O-ring for breathing hose | R06-0202 |
| 39. Flat gasket for hose SR 541 | R06-0506 |
| 40. Gasket for fan | R06-0107 |
| 41. Plug kit | R06-0703 |

